

**ART. 18**

Gomito a 45° M.F.  
M.F. yellow brass elbow 45°.



- R E -

**Fig. 121**

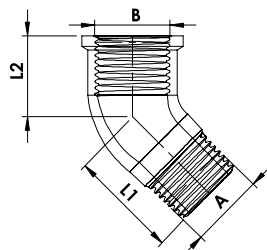

Codice - Code	Ø AxB	L1 mm	L2 mm	Conf. - Pack		€ Cad. - € each
1188108	1/2"	30,3	22,8	10	150	3,75
1188109	3/4"	33,7	23,0	10	100	4,45
1188110	1"	38,6	26,8	10	60	6,85
1188111	1"1/4	45,8	33,0	1	36	9,80
1188112	1"1/2	45,8	38,1	1	15	15,50
1188113	2"	53,1	42,5	1	6	25,60

**ART. 20**

Raccordo a TEE.  
TEE yellow brass joint.



- R E -

**Fig. 130**

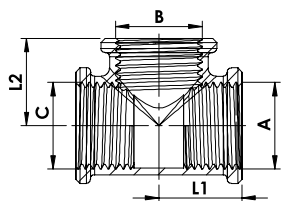

Codice - Code	Ø AxBxC	L1 mm	L2 mm	Conf. - Pack		€ Cad. - € each
1185456	1/4"	17,7	17,5	10	120	2,20
1185457	3/8"	21,0	21,1	10	120	2,58
1185458	1/2"	20,0	21,1	10	120	2,20
1185459	3/4"	25,4	25,3	10	70	3,55
1185460	1"	30,8	32,0	10	40	6,25
1185461	1"1/4	41,9	41,0	1	26	10,70
1185462	1"1/2	46,8	47,0	1	18	15,15
1185463	2"	52,5	51,0	1	10	22,00
1185464	2"1/2	70,0	70,0	1	4	64,20
1185465	3"	75,0	75,0	1	2	84,10
1185467	4"	92,5	92,5	1	1	151,00

**ART. 22**

TEE per impieghi speciali: navale e gas.  
Heavy TEE yellow brass joint.



- R E -

**Fig. 130**  
PER IMPIEGHI SPECIALI:  
NAVALE E GAS

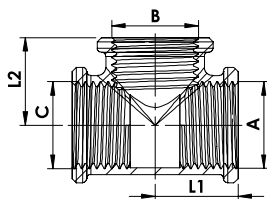

Codice - Code	Ø AxBxC	L1 mm	L2 mm	Conf. - Pack		€ Cad. - € each
1185492	1/2"	24,8	24,9	10	100	3,65
1185493	3/4"	30,3	30,3	10	50	6,40
1185494	1"	34,9	35,5	10	35	8,92
1185496	1" 1/2	48	48	1	18	21,40

**ART. 24**

TEE ridotto.  
Reduced TEE yellow brass.



- R E -

**Fig. 130R**

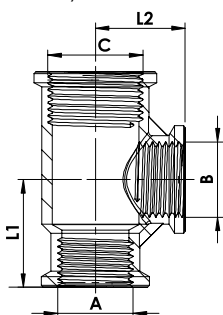

Codice - Code	Ø AxBxC	L1 mm	L2 mm	Conf. - Pack		€ Cad. - € each
1185470	3/4"x1/2"x3/4"	30,0	25,0	10	80	4,50
1185469	3/4"x1/2"x1/2"	26,0	25,6	10	60	5,95
1185471	1"x1/2"x1"	27,5	29,6	10	50	6,25
1185485	1"x1"x1/2"	32,5	32,5	10	20	11,00
1185472	1"x3/4"x1"	37,0	36,9	10	40	7,15