

## ART. 50

Nipples doppio ridotto.  
Yellow brass reducing nipple.



- R E -

Fig. 245

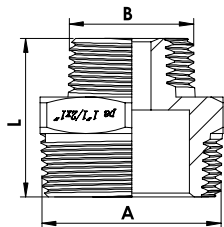

Codice - Code	Ø AxB	L mm	Conf. - Pack		€ Cad. - € each
			📦	📦	
1186053	1/4"x1/8"	23,0	10	400	0,68
1186057	3/8"x1/4"	25,0	10	400	0,92
1186056	1/2"x1/4"	24,5	10	400	1,25
1186058	1/2"x3/8"	27,4	10	400	0,98
1186062	3/4"x3/8"		10	200	2,48
1186059	3/4"x1/2"	29,6	10	280	1,55
1186061	1"x1/2"	35,2	10	130	2,56
1186060	1"x3/4"	32,9	10	130	2,70
1186067	1"1/4x3/4"		10	80	7,30
1186068	1"1/4x1"	37,2	1	60	4,30
1186065	1"1/2x3/4"		5	50	9,80
1186073	1"1/2x1"	44,5	1	90	6,10
1186069	1"1/2x1"1/4	44,5	1	50	6,10
1186070	2"x1"		5	30	11,30
1186071	2"x1"1/4	47,0	1	40	9,20
1186072	2"x1"1/2	48,8	1	40	10,26
1186075	2" 1/2x2"	62,3	1	6	25,30

## ART. 52

Bocchettone dritto M.F. con OR.  
O-ring seal straight yellow brass pipe union.



- R E -

CON O-RING

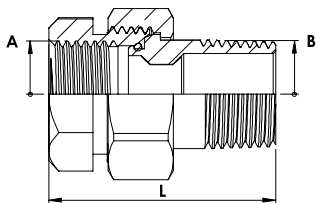

Codice - Code	Ø AxB	L mm	Conf. - Pack		€ Cad. - € each
			📦	📦	
1181207	3/8"	41,0	10	200	4,00
1181208	1/2"	44,5	10	150	3,20
1181209	3/4"	50,3	10	80	5,05
1181210	1"	57,6	10	50	8,05
1181211	1"1/4	66,9	1	34	13,40
1181212	1"1/2	75,0	1	20	18,75
1181213	2"	92,9	1	11	36,60

## ART. 54

Bocchettone curvo M.F. con OR.  
O-ring seal bent yellow brass pipe union.



- R E -

CON O-RING

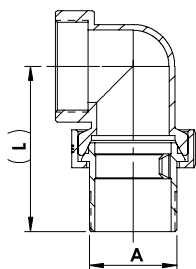

Codice - Code	Ø A	L mm	Conf. - Pack		€ Cad. - € each
			📦	📦	
1181407	3/8"	45,0	10	100	5,20
1181408	1/2"	48,3	10	80	4,45
1181409	3/4"	61,3	10	50	7,45
1181410	1"	71,1	10	34	11,15
1181411	1"1/4	74,6	1	20	18,45
1181412	1"1/2	91,4	1	14	25,90
1181413	2"	101,0	1	6	56,50

## ART. 55

Bocchettone dritto M.F. 3 pezzi  
sede piana con guarnizione.  
3 pcs straight fitting M.F. with gasket.



SEDE PIANA

Codice - Code	Ø	Conf. - Pack		€ Cad. - € each
		📦	📦	
1181658	1/2"	10	200	3,86
1181659	3/4"	10	120	6,10
1181660	1"	10	60	10,70
1181661	1"1/4	1	40	14,30
1181662	1"1/2	1	20	23,20
1181663	2"	1	12	41,62