

ART. 26

Croce.
Yellow brass cross.



- R E -

Fig. 180

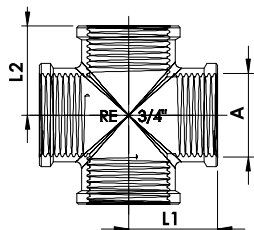

Codice - Code	Ø AxB	L1 mm	L2 mm	Conf. - Pack		€ Cad. - € each
1186758	1/2"	23,4	23,4	10	80	3,45
1186759	3/4"	28,3	28,3	10	40	4,75
1186760	1"	35,0	35,0	10	30	8,50
1186761	1"1/4	40,0	40,0	1	20	16,35
1186762	1"1/2	46,5	46,5	1	15	21,60
1186763	2"	56,5	56,5	1	6	31,20

ART. 28

Manicotto.
Yellow brass coupling.



- R E -

Fig. 270

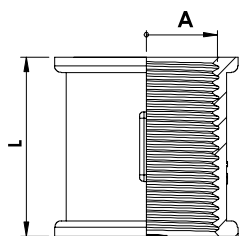

Codice - Code	Ø	L	Conf. - Pack		€ Cad. - € each
1185656	1/4"	17,5	10	500	0,75
1185657	3/8"	30,0	10	300	1,35
1185658	1/2"	30,0	10	240	1,50
1185659	3/4"	33,0	10	150	1,93
1185660	1"	30,5	10	100	2,97
1185661	1"1/4	36,2	1	60	4,00
1185662	1"1/2	40,0	1	50	6,55
1185663	2"	50,0	1	30	10,12

ART. 30

Nipples doppio.
Yellow brass nipples.



- R E -

Fig. 280

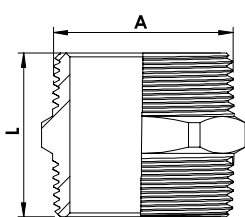

Codice - Code	Ø A	L mm	Conf. - Pack		€ Cad. - € each
1185856	1/4"	22,3	10	500	0,71
1185857	3/8"	28,0	10	400	0,90
1185858	1/2"	29,3	10	380	1,01
1185859	3/4"	30,4	10	240	1,52
1185860	1"	34,5	10	140	2,38
1185861	1"1/4	39,6	1	70	4,16
1185862	1"1/2	41,00	1	65	5,50
1185863	2"	52,2	1	36	8,95
1185884	2"1/2	61,4	1	10	29,75
1185885	3"	64,0	1	6	41,62
1185887	4"	68,3	1	2	68,35

ART. 32

Nipples conico per impieghi speciali: navale e gas.
Heavy yellow brass nipples.



- R E -

Fig. 280
**PER IMPIEGHI SPECIALI:
NAVALE E GAS**

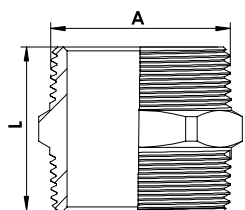

Codice - Code	Ø A	L mm	Conf. - Pack		€ Cad. - € each
1185892	1/2"	40,0	10	250	1,78
1185893	3/4"	43,9	10	150	2,97
1185894	1"	47,4	10	80	4,16
1185896	1" 1/2	57,0	1	36	9,50